

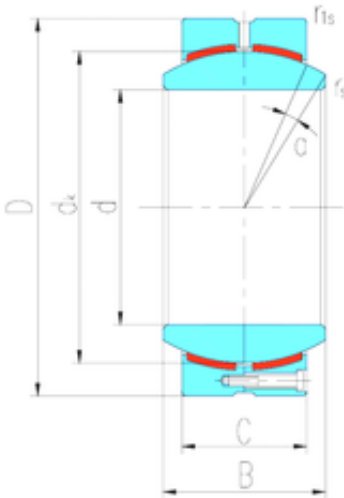

DEARING OF AMERICA CORP.



340 mm x 460 mm x 160 mm LS GEC340HC
plain bearings

Bearing No. GEC340HC

Size	340x460x160 mm
Bore Diameter	340 mm
Outer Diameter	460 mm
Width	160 mm
d	340 mm
D	460 mm
B	160 mm
C	135 mm
dk	400 mm
r min.	1,1 mm
r1 min.	3 mm
Angle	3 °
Weight	83 Kg
Basic dynamic load rating (C)	5400 kN

GEC340HC Bearing 2D drawings and 3D CAD models