

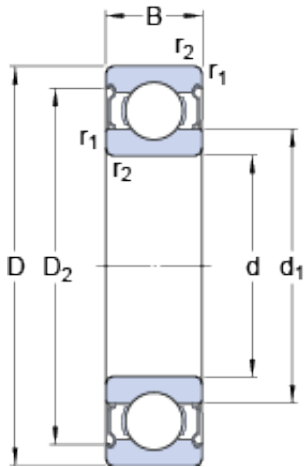

DEARING OF AMERICA CORP.



25 mm x 37 mm x 10 mm SKF W 63805-2Z
deep groove ball bearings

Bearing No. W 63805-2Z

W 63805-2Z Bearing 2D drawings and 3D CAD models

Size	37x25x10 mm
Bore Diameter	37 mm
Outer Diameter	25 mm
Width	10 mm
d	25 mm
D	37 mm
B	10 mm
d ₁	28.2 mm
D ₂	34.12 mm
r _{1,2} - min.	0.3 mm
d _a - min.	27 mm
d _a - max.	28 mm
D _a - max.	35 mm
r _a - max.	0.3 mm
Basic dynamic load rating - C	3.9 kN
Basic static load rating - C ₀	2.6 kN
Fatigue load limit - P _u	0.108 kN
Reference speed	38000 r/min
Limiting speed	19000 r/min
Calculation factor - k _r	0.02
Calculation factor - f ₀	13.7
d ₁	28.2 mm
D ₂	34.12 mm
r _{1,2} min.	0.3 mm



DEARING OF AMERICA CORP.

d_a min.	27 mm
d_a max.	28 mm
D_a max.	35 mm
r_a max.	0.3 mm
Basic dynamic load rating C	3.38 kN
Basic static load rating C_0	2.5 kN
Fatigue load limit P_u	0.108 kN
Calculation factor k_r	0.02
Calculation factor f_0	13.7
Mass bearing	0.029 kg